

BUILDING PERMIT

DATE _____ 20 _____

PERMIT # _____

Applicant Name: _____

Address: _____

Telephone #: _____

PERMIT FEES:

Up to & including the 1st \$1,000 - \$10.00

Each \$1,000 increments above \$1,000 - \$1.00

Legal Description: _____

Residential: _____ Commercial: _____

New Construction: _____ Alterations: _____

____ House ____ Shed ____ Garage ____ Car Port ____ Deck ____ Patio ____ Other

Size of the project application is for: _____

Please describe in detail materials to be used including roofing, interior &/or exterior materials: _____

Is the building to be connected to City Utilities in compliance with City Ordinances, Chapter 3, Article 1, 2 and 3. Copies of the City Ordinances are available upon request.

____ Electric ____ Water ____ Sewer

IMPORTANT: All electrical work must be performed by a licensed electrician.

Applicant agrees to keep construction area as clean and tidy as possible so that debris will not blow or be carried on to surrounding properties, and further agrees not to use the City of Red Cloud's streets as storage for building material or cause any destruction to city property without prior written approval.

By signing the document the applicant acknowledges he/she has read the regulations and will abide by said regulations or be in violation of zoning ordinances.

Applicant's Signature X _____ Estimated Cost \$ _____

Approved this _____ day of _____ 20 _____

Approved by:

PERMIT FEE: \$ _____

Mike Clark, City Superintendent
Todd Brown, Mayor

PERMITS ARE VALID FOR ONE YEAR FROM DATE OF APPROVAL!!

DEFINE BELOW, AS CLOSE AS POSSIBLE THE LOCATION OF THE BUILDING, FENCE, ETC. ON LOT OR LOTS, ALSO DISTANCE FROM SIDEWALK.

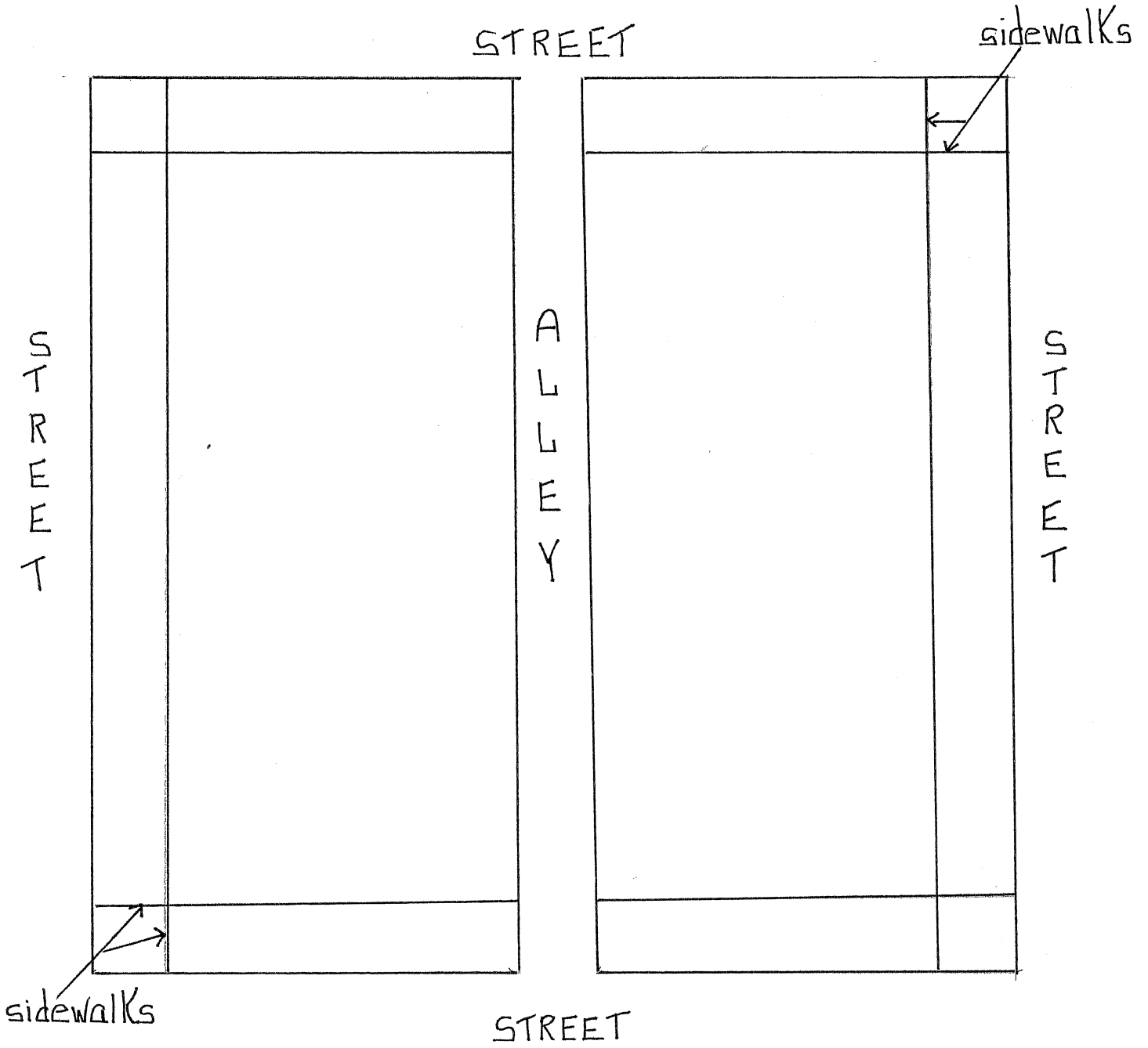

Set backs for a house

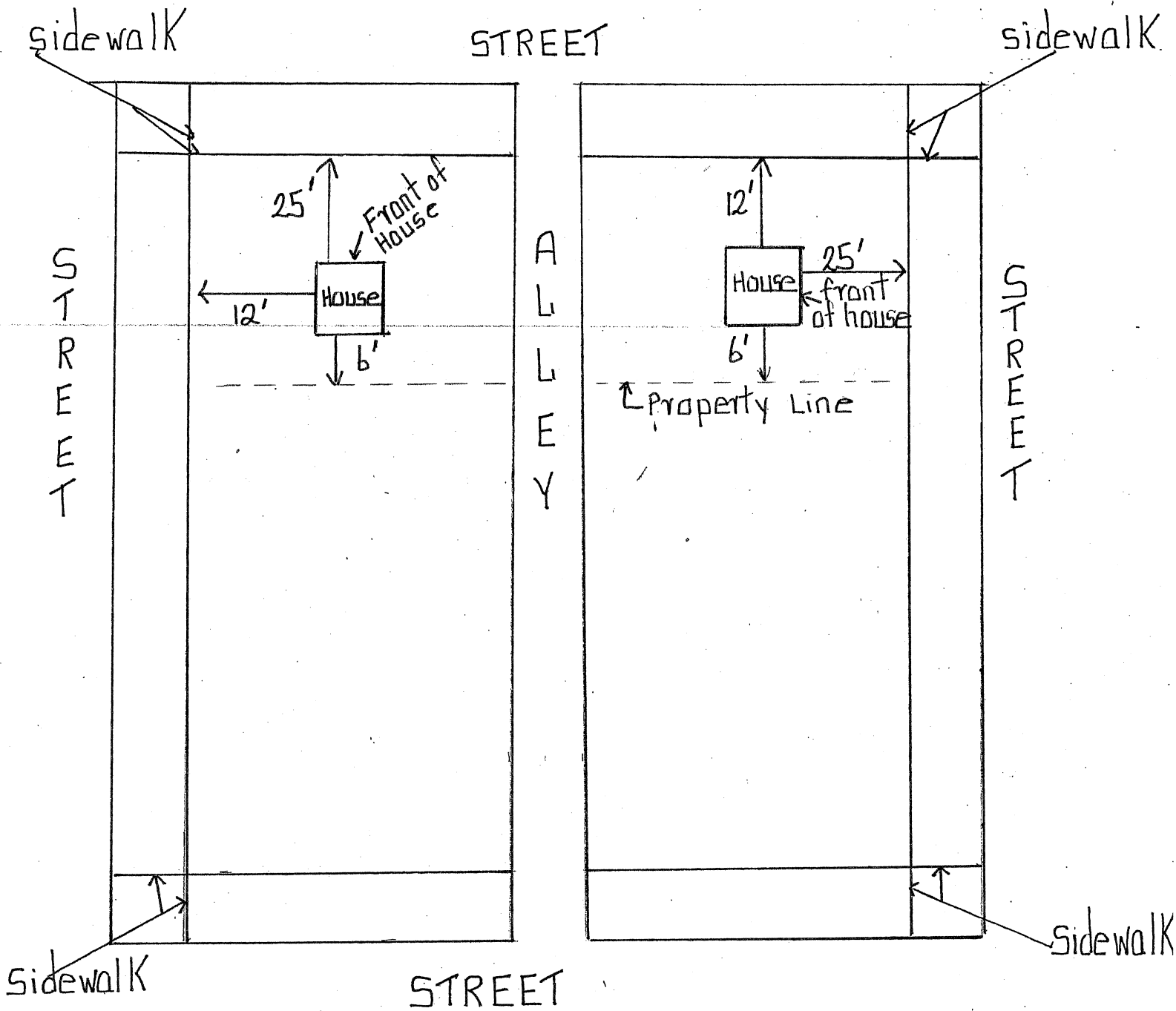

SET BACK REGULATIONS FOR A HOUSE

The front of the house has to be 25' from the eaves to the sidewalk and 6' from the eaves to the property line and the side of the house must be 12' from the eaves to the property line.

The property line is usually 1' inside of the sidewalk.

Set backs for Garage / Shed

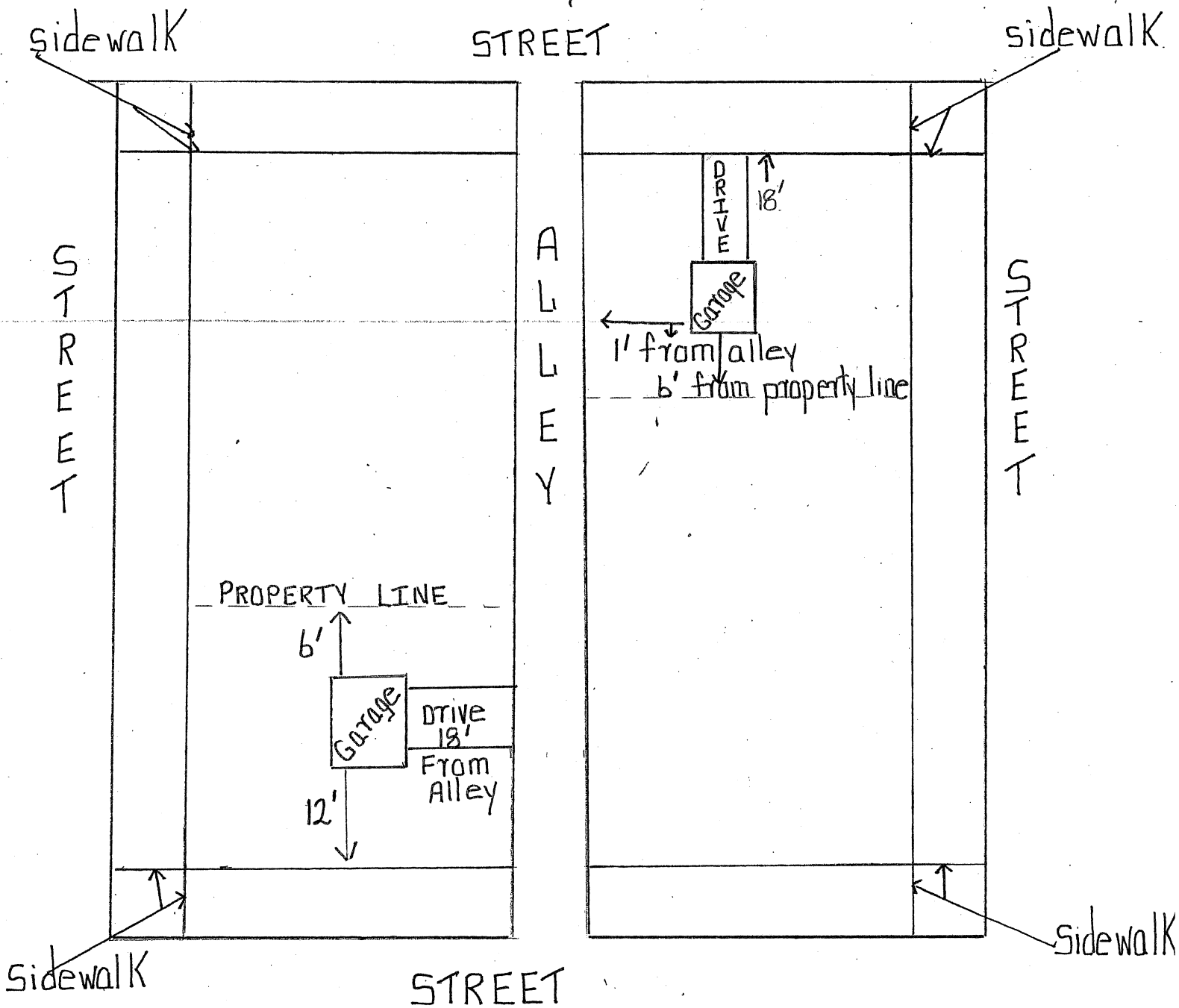

SET BACKS FOR A GARAGE/SHED

If entry into the garage is from the alley, it must be back 18' from the alley, the eaves of garage must be 6' from the property line and 12' from the eaves to the property line.

If the garage runs with the alley, the eaves of the garage must be 1' from the alley and 18' from the property line.