

FENCE PERMIT

PERMIT# \_\_\_\_\_

DATE \_\_\_\_\_

APPLICANT NAME: \_\_\_\_\_

ADDRESS: \_\_\_\_\_

TELEPHONE # \_\_\_\_\_

**PERMIT FEES**

Up to & including the 1<sup>st</sup> \$1,000 - \$10.00

Each \$1,000 increments above \$1,000 - \$1.00

LEGAL DESCRIPTION: \_\_\_\_\_

RESIDENTIAL: \_\_\_\_\_ COMMERCIAL: \_\_\_\_\_

HEIGHT: \_\_\_\_\_ LENGTH: \_\_\_\_\_

FENCING MATERIAL:

\_\_\_ WOOD \_\_\_ CHAIN LINK \_\_\_ PVC/RESIN \_\_\_ STONE/MASONRY \_\_\_ OTHER

IF OTHER DESCRIBE IN DETAIL \_\_\_\_\_

\_\_\_\_\_

\_\_\_\_\_

**WOOD FENCES SHALL UTILIZE STANDARD BUILDING LUMBER ONLY. BARBED WIRE AND/OR ELECTIFIED FENCES ARE NOT PERMITTED.**

Estimated cost \$ \_\_\_\_\_

*I certify that I have read all the rules and regulations attached to said permit and agree to build my fence in accordance.*

Applicant's Signature X \_\_\_\_\_

Approved this \_\_\_\_\_ day of \_\_\_\_\_ 20 \_\_\_\_\_

PERMIT FEE: \_\_\_\_\_

APPROVED BY:

\_\_\_\_\_  
Mike Clark, City Superintendent  
Todd Brown, Mayor

**PERMITS ARE VALID FOR ONE YEAR FROM DATE OF APPROVAL!**

DEFINE BELOW, AS CLOSE AS POSSIBLE THE LOCATION OF THE BUILDING, FENCE, ETC. ON LOT OR LOTS, ALSO DISTANCE FROM SIDEWALK.

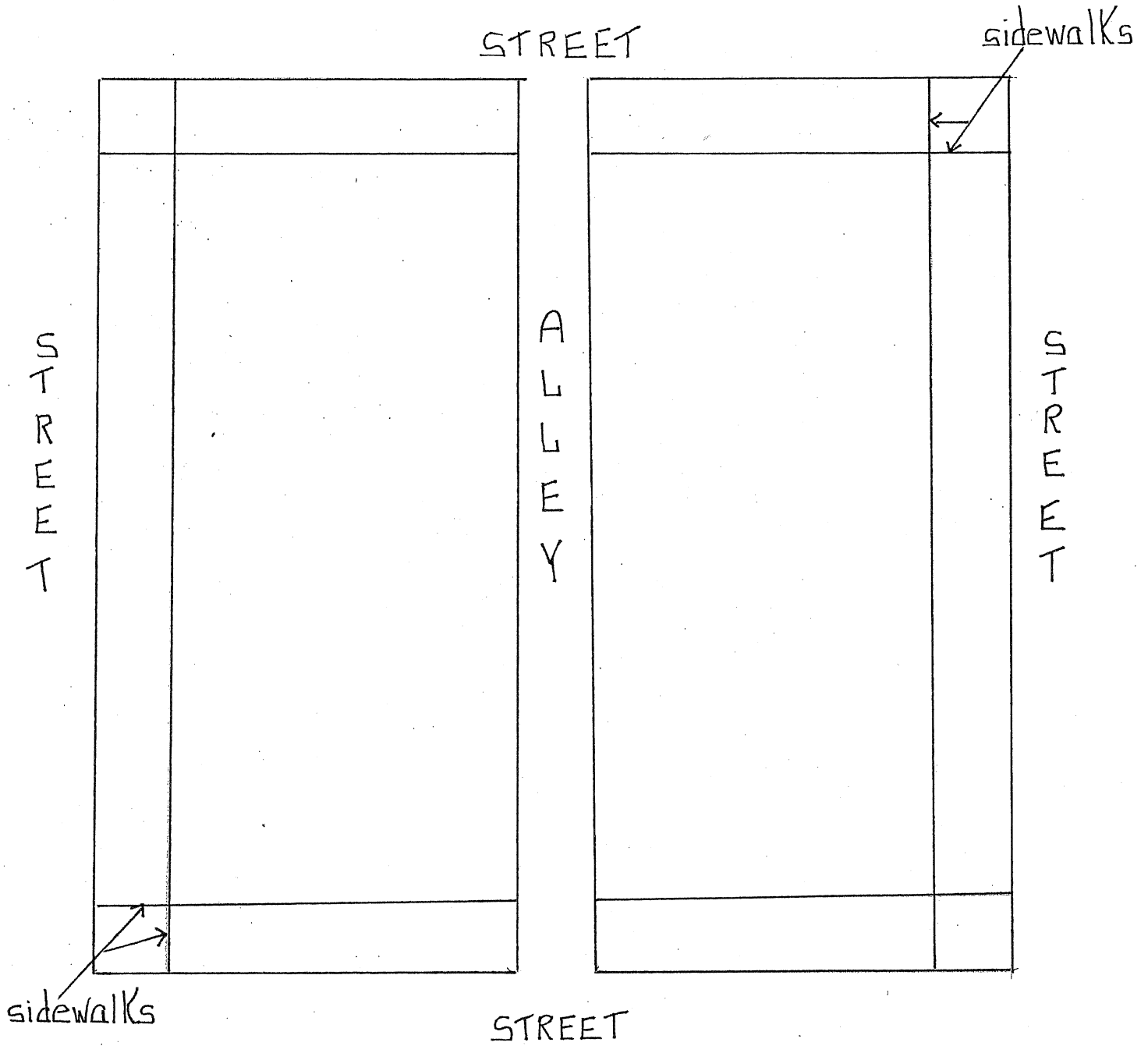

SUPPLEMENTAL SITE DEVELOPMENT REGULATIONS

36.707 Fence Regulations

a. Location Restriction

Unless otherwise provided by this Ordinance or other sections of the Red Cloud Municipal Code, no fence shall be built on any lot or tract outside the surveyed lot lines, or tract outside the surveyed lot lines, or adjacent to any Municipal property, excluding public streets.

b. Required Openings

Unless otherwise provided by this Ordinance or other sections of the Red Cloud Municipal Code, any fence built on residential property within required front or street side yards shall contain openings constituting no less than 50 percent of the surface area of the fence.

c. Sight Obstruction

No solid fence permitted or required by this article or other sections of the Red Cloud Municipal Code shall be built within a triangle formed by the adjacent side lines of two intersecting streets and a line connecting points 30 feet on each leg from their point of intersection; or otherwise in any manner create a traffic hazard or obstruction to visibility.

d. Facing

The finished surfaces of any fence shall face toward adjacent properties and street frontage.

e. Effect on Adjacent Properties

No accessory building shall damage adjacent property by obstructing views, inhibiting solar access, or hindering ventilation.

f. Residential Fences

Fences constructed within residential districts or on land used for residential purposes are subject to the following provisions.

1. Height: The maximum height of a fence within a required front yard or street side yard setback shall be four feet. The maximum height for any fence outside of a required front yard shall be six feet.

2. Exception for Street Side Yards: On corner lots, a fence built parallel to the street side yard line but set back in conformance with the required street yard setback may have a maximum height of six feet.

3. Exception to Openness Requirement: Fences built on residential property outside of required front or street side yards may exceed of 50 percent closed construction.

4. Exception for Front Yards of Double Frontage Lots: A fence built within the required front yard of a double frontage lot may be a maximum of six feet in height and may exceed 50 percent closed construction if such lot fronts an arterial street or expressway, as defined in the Comprehensive Development Plan of the City of Red Cloud; and if such frontage does not provide primary access to the property.

*25' set back / can only be 6' high after 25' set back*

## SUPPLEMENTAL SITE DEVELOPMENT REGULATIONS

---

5. Materials: Fences shall be constructed of wood, chain-link, PVC/ resin, stone or masonry materials only. Wood fences shall utilize standard building lumber only. Barbed wire and/or electrified fences are not permitted, and are defined as any fence that includes in its material barbs, blades, razors, electric current or other features specifically designed to injure or abrade an individual or animal who attempts to negotiate the fence.

f. Civic, Office, Commercial, and Industrial Fences

Fences constructed in commercial and industrial districts are subject to the following special provisions:

1. The maximum height of a fence for any permitted use in any non-residential zoning district shall be eight feet.
2. Civic Uses in Residential Districts: The maximum height of fences installed as part of Primary and Secondary Educational Facilities or Park and Recreation Use Types within Residential Zoning Districts shall be eight feet.
3. The Board of Adjustment may approve greater fence heights on a case-by-case basis if it concludes that such permission furthers the health, safety, and welfare of the residents of the City of Red Cloud.
4. Barbed wire shall not be used in the construction of any fence outside of the GI General Industrial Zoning District. Barbed wire may be used in the construction of fencing in an industrial district provided that the bottom strand of the wire shall be at least six feet above ground level. Electrified fences are not permitted within the jurisdiction of the City of Red Cloud.

### 36.708 Appeals

Denial, revocations, or cancellations of a building permit based on the provisions of this Section may be appealed to the Board of Adjustment, as set forth in Sections 1208 through 1210.