

SIGN PERMIT

PERMIT # _____

DATE _____

Applicant's Name: _____

Address: _____

Telephone #: _____

PERMIT FEES:

Up to & including the 1st \$1,000 - \$10.00

Each \$1,000 increments above \$1,000 - \$1.00

Residential _____

Commerical _____

Sign Type _____ Sign Size _____

Attached to building: _____ Yes _____ No If yes state how it is attached: _____

Detached: _____ Yes _____ No If yes state how the sign will be supported _____

Illuminated: _____ Yes _____ No If yes state how it is illuminated _____

Have contacted the State Dept. of Roads if signs falls within the State Highway right-of-way ___ Yes ___ No

ESTIMATED COST: \$ _____

I certify that I have read the attached rules and regulations pertaining to signs and will install my sign in accordance.

Applicant's Signature X _____

APPROVED BY:

Approved this _____ day of _____ 20_____

PERMIT FEE: \$ _____

Mike Clark, City Superintendent
Todd Brown, Mayor

PERMITS ARE VALID FOR ONE YEAR FROM DATE OF APPROVAL!!

DEFINE BELOW, AS CLOSE AS POSSIBLE THE LOCATION OF THE BUILDING, FENCE, ETC. ON LOT OR LOTS, ALSO DISTANCE FROM SIDEWALK.

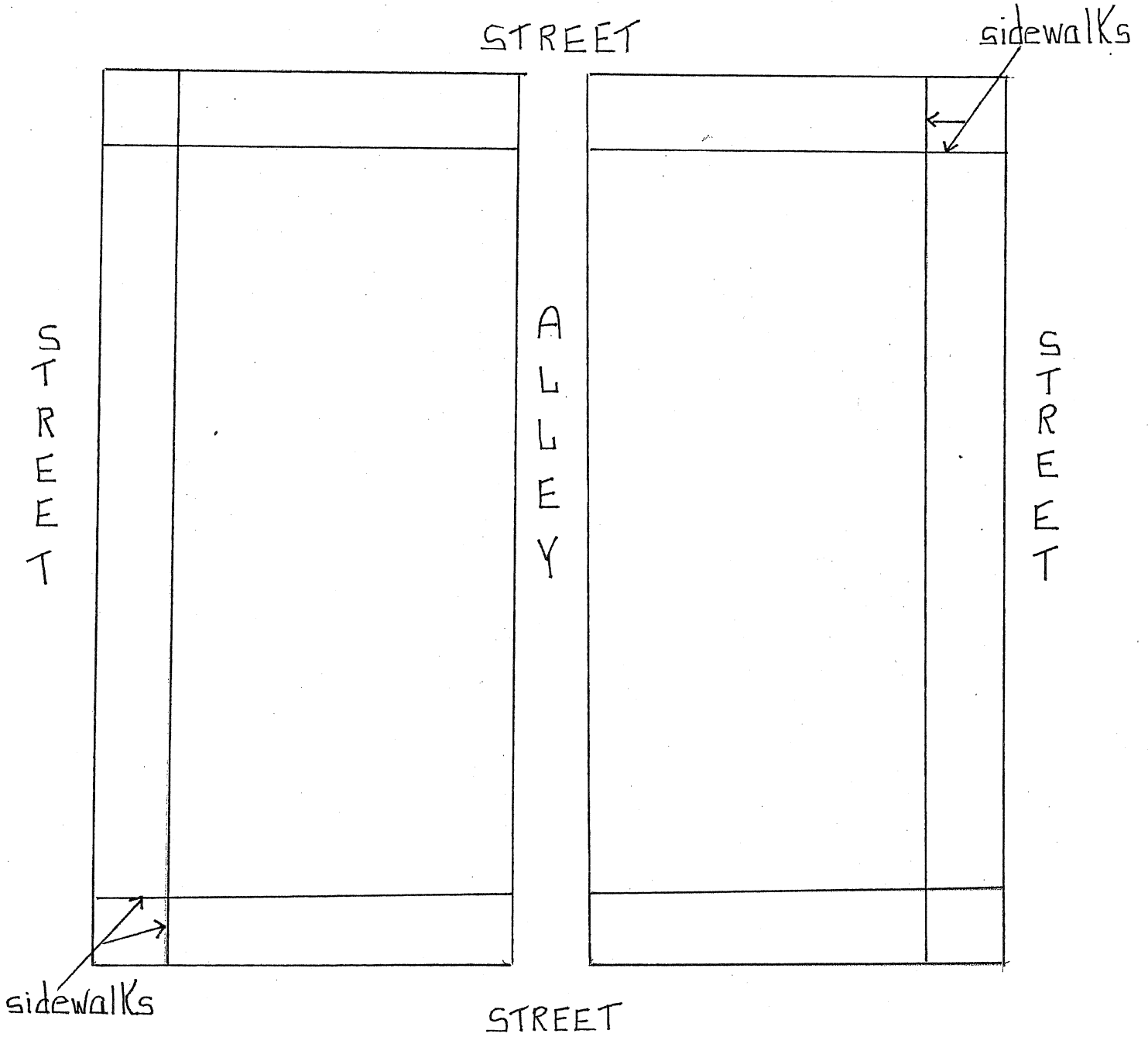

SIGN REGULATIONS

Table 10-3: Permitted Signs by Maximum Permitted Area and District

This Maximum Permitted Area for all signs on a premises excluding incidental signs, building marker signs, and flags shall not exceed the lesser of the following:

| Zoning District | AG | RR R-1 R-2 | R-3 MH | TC | GC | LI GI |
|----------------------------------------------------|---------------|------------------|-----------|-----|---------------|---------------|
| Square Feet of Signage per Linear Foot of Frontage | NA | NA | NA | 2.0 | 3.0 | 2.0 |
| General Maximum Sign Size Regulations | Note 1 | Note 2 | Note 3 | | Note 5 | Note 5 |
| Detached Signs | | | | | | |
| Number Permitted Per Premise | 1 | 1 | 1 | 1 | NA | NA |
| Per Feet of Frontage | NA | NA | NA | NA | 1 per 200 | 1 per 200 |
| Maximum Size* (square feet) | 300 Note 6 | Note 2 | Note 3 | 100 | 300 Note 6 | 300 Note 6 |
| Maximum Height of Structure Above Ground (feet) | 45 | 10 | 10 | 25 | 35 | 35 |
| Front Yard Setback (feet) | 25 | 5 | 10 | 0 | 5 | 0 |
| Side Yard Setback (feet) | 10 | 10 | 10 | 0 | 5 | 0 |
| Attached Signs | | | | | | |
| Maximum Size* (square feet) | 100 | Note 2 | Note 3 | NA | 300 | 300 |
| % of Street Facade | NA | | | 20% | 25% | 25% |

SIGN REGULATIONS

Notes to Table 10-3

Note 1:

Maximum sign size is 200 square feet for civic or commercial uses, 2 square feet for residential uses, including home occupations.

Note 2:

Maximum sign size is 100 square feet for project identification signs; 32 square feet for civic uses, 2 square feet for residential uses, including home occupations.

Note 3:

Maximum sign size is 32 square feet for civic uses, 100 square feet for project identification signs for multi-family or mobile home developments and for non-residential uses when permitted, 2 square feet for residential uses, including home occupations.

Note 4:

On premises with primary residential use, maximum sign size is 75 square feet for project identification signs for multi-family developments, 2 square feet for residential uses, including home occupations.

Note 5:

In addition to its total permitted sign area, each premises used for a business center may have one detached center identification sign, subject to the following conditions:

1. The maximum area for a center identification sign shall be 150 square feet.
2. No center identification sign shall be within 300 feet of any other center identification sign or within 150 feet of any other detached sign on the same or adjacent premises.
3. The sign shall display no more than the name and location of the business center.
4. Each sign shall be subject to all other regulations for detached signs or graphics set forth in this Article.